

# 3 D P R I N T E D **FORKLIFT** **WIRELESS CHARGER**

A design model for the Bambu Lab Wireless Charger Kit-K012

## **Assembly Guide**



# 1 | Install Circuit Board & LED Lights

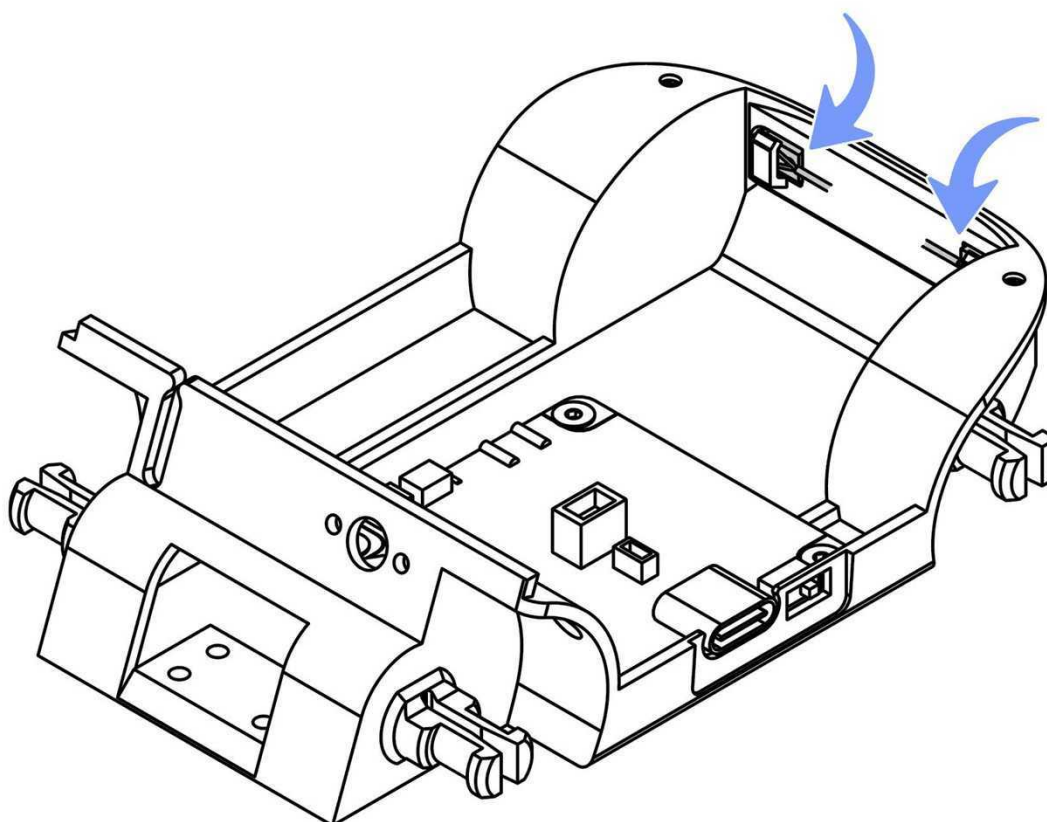
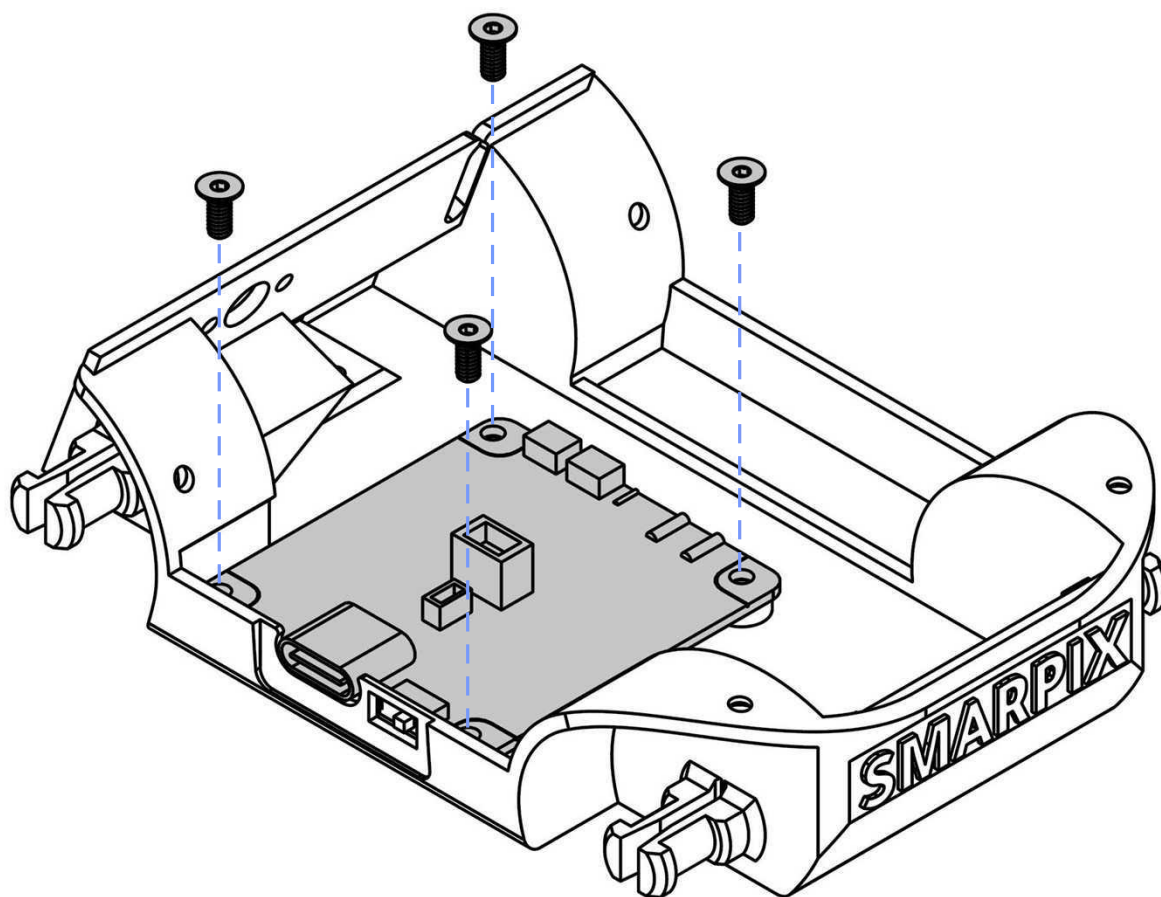

## 2 | Install Switch Board

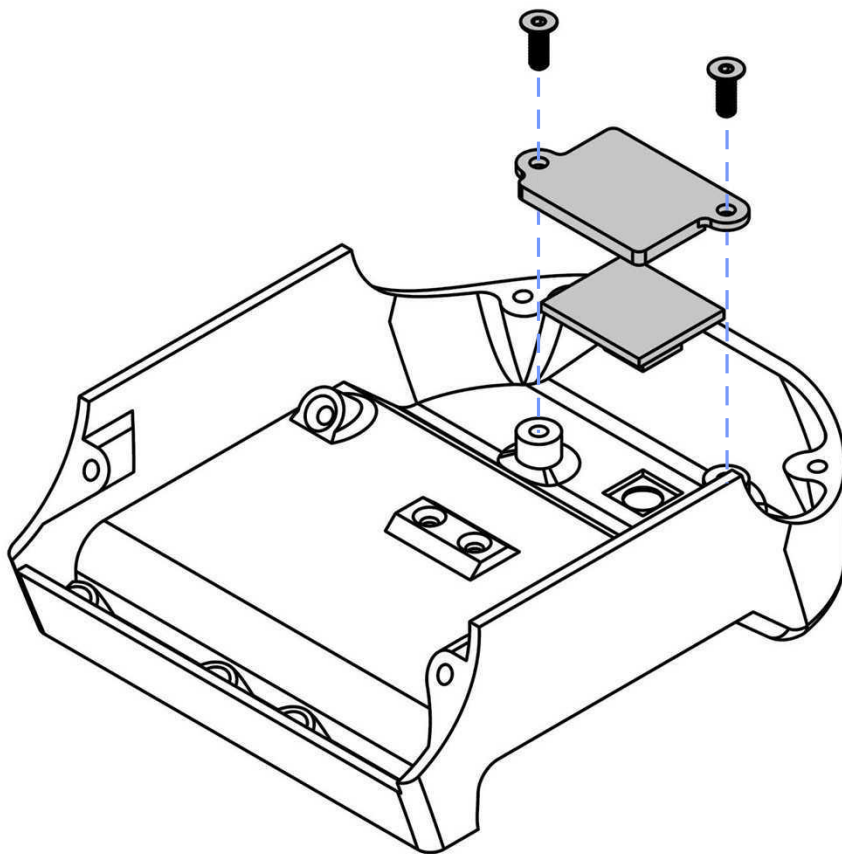

---

## 3 | Install Seat

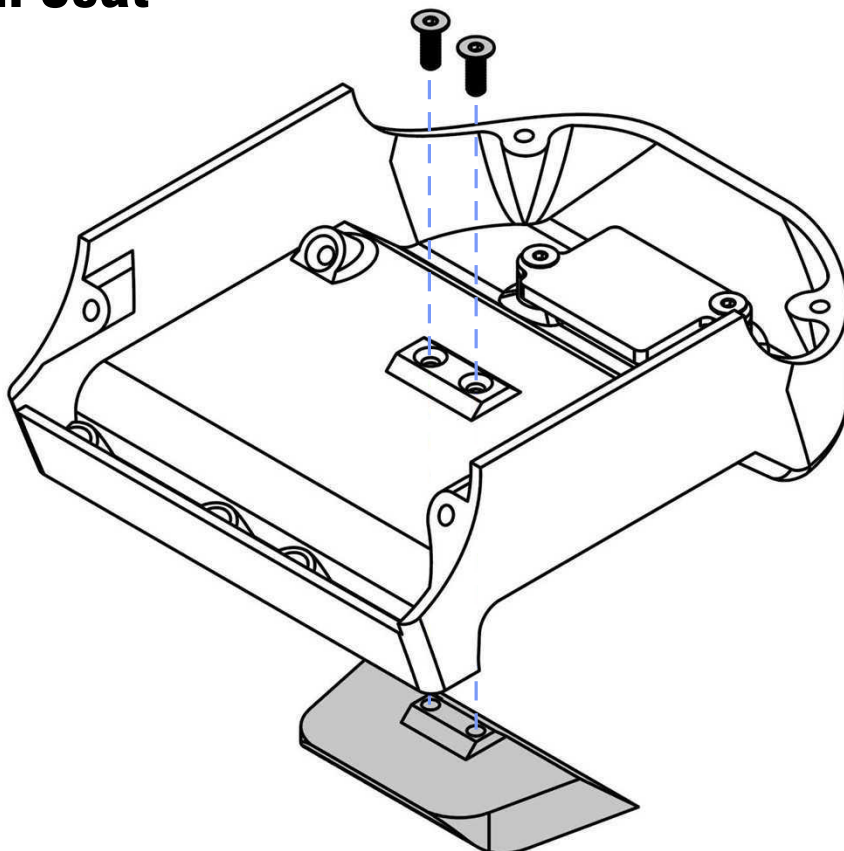

# 4 | Install Driver Cab & Steering Wheel

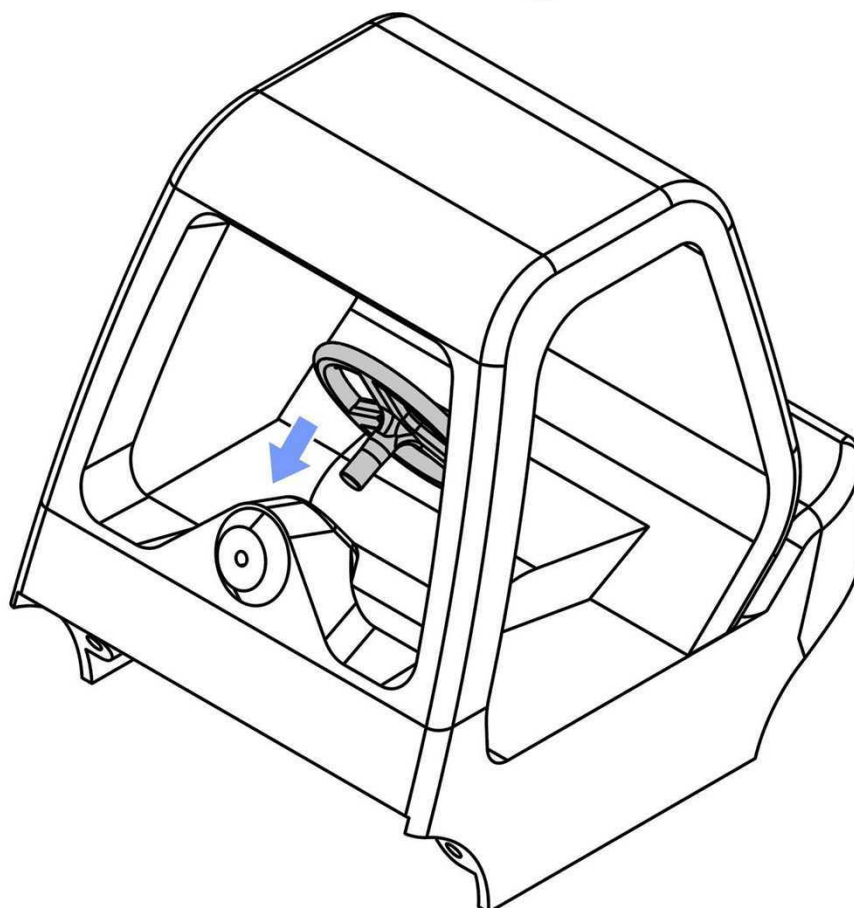
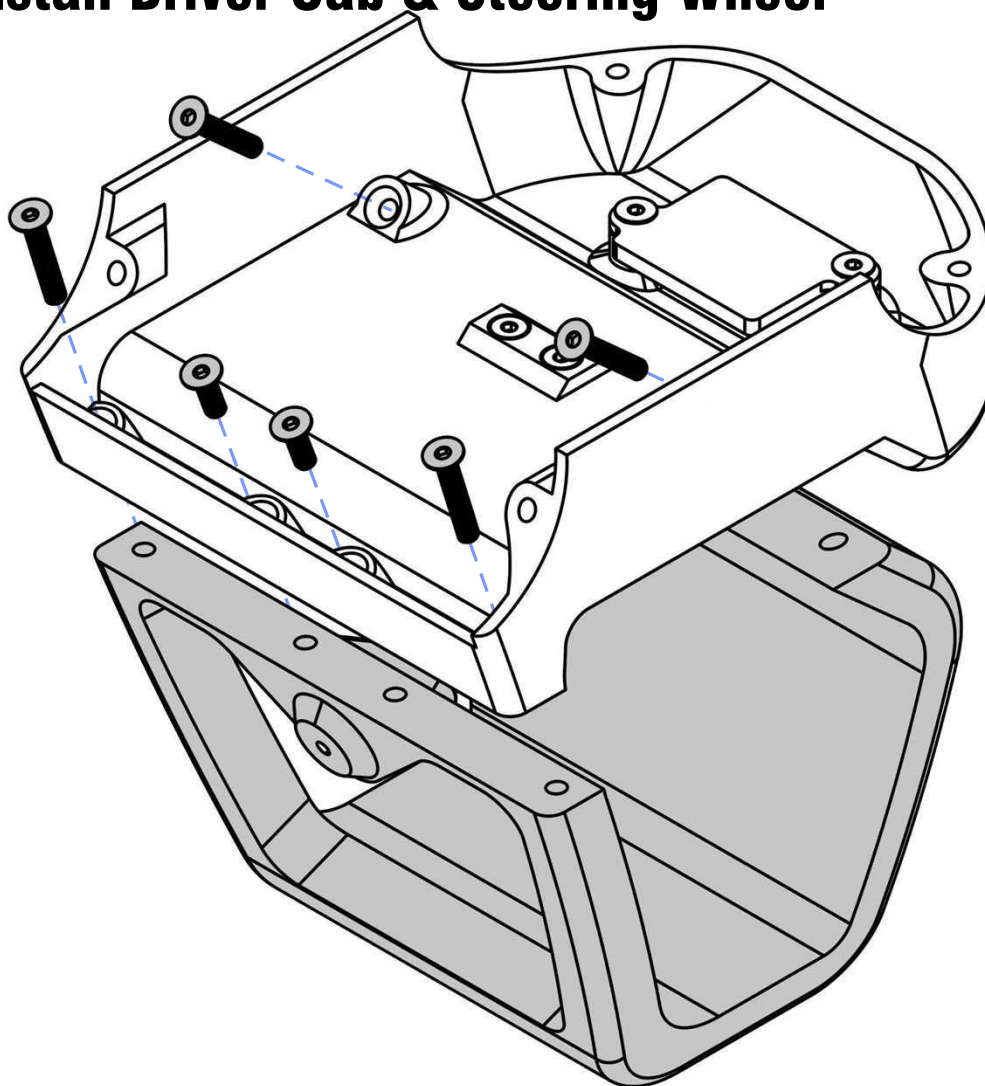



## 5 | Install Motor

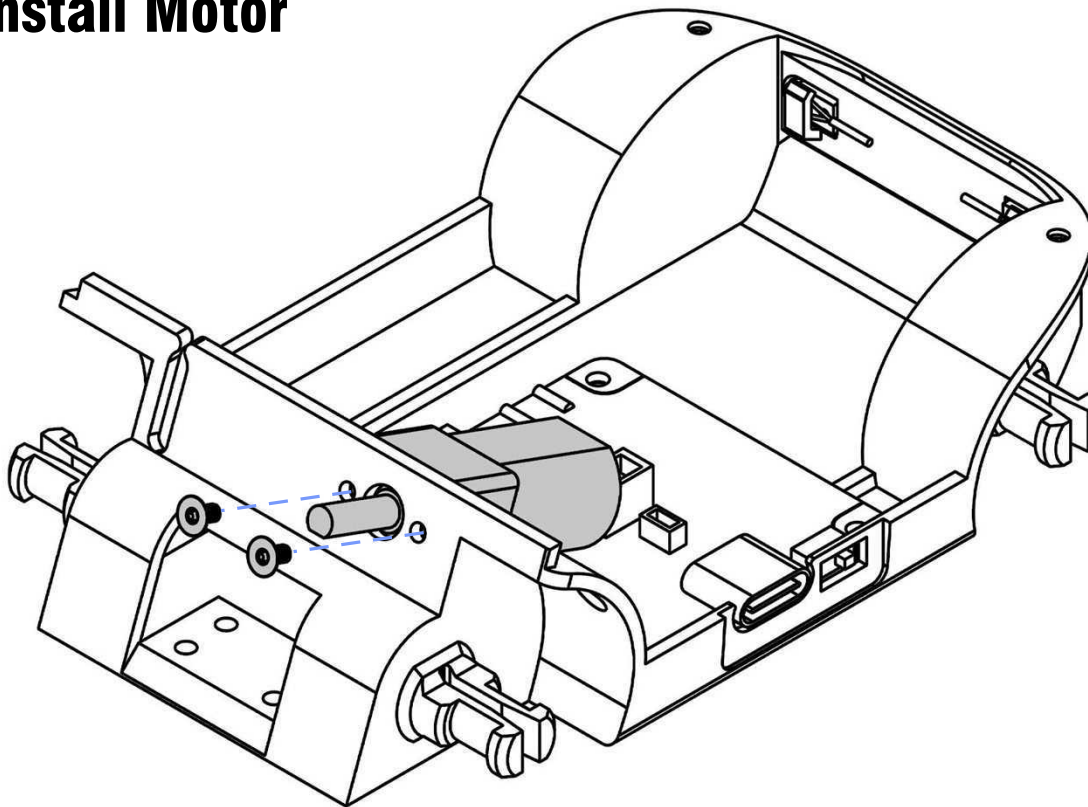

---

## 6 | Join Body Parts

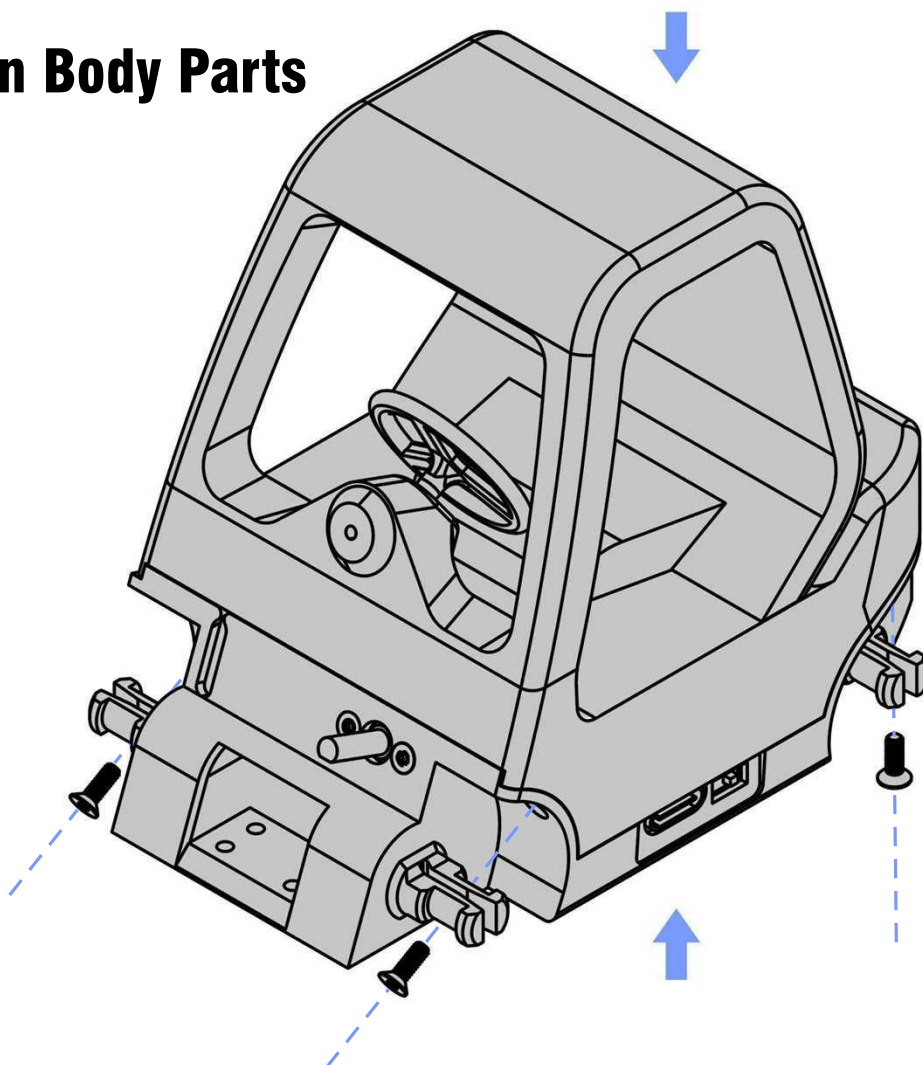

## 7 | Install Gears

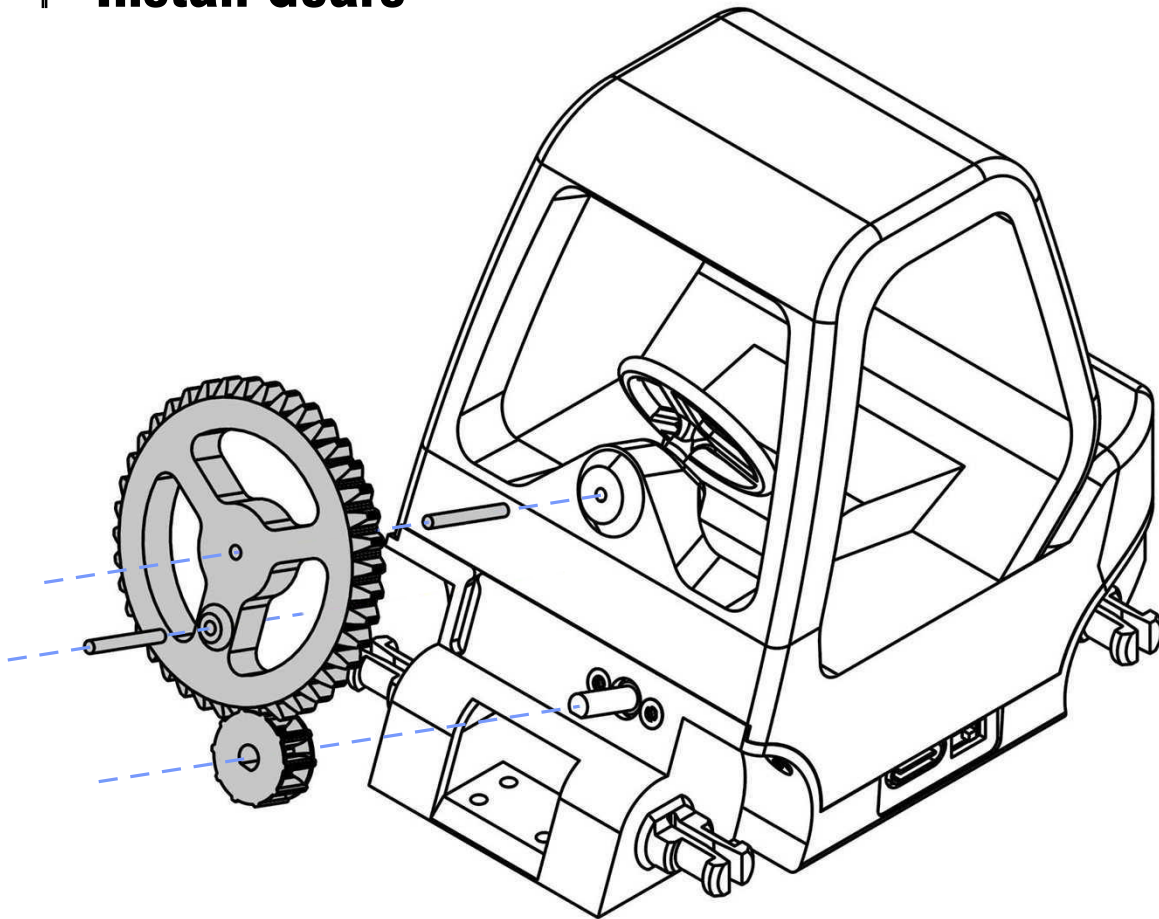

---

## 8 | Mount Mast Forks

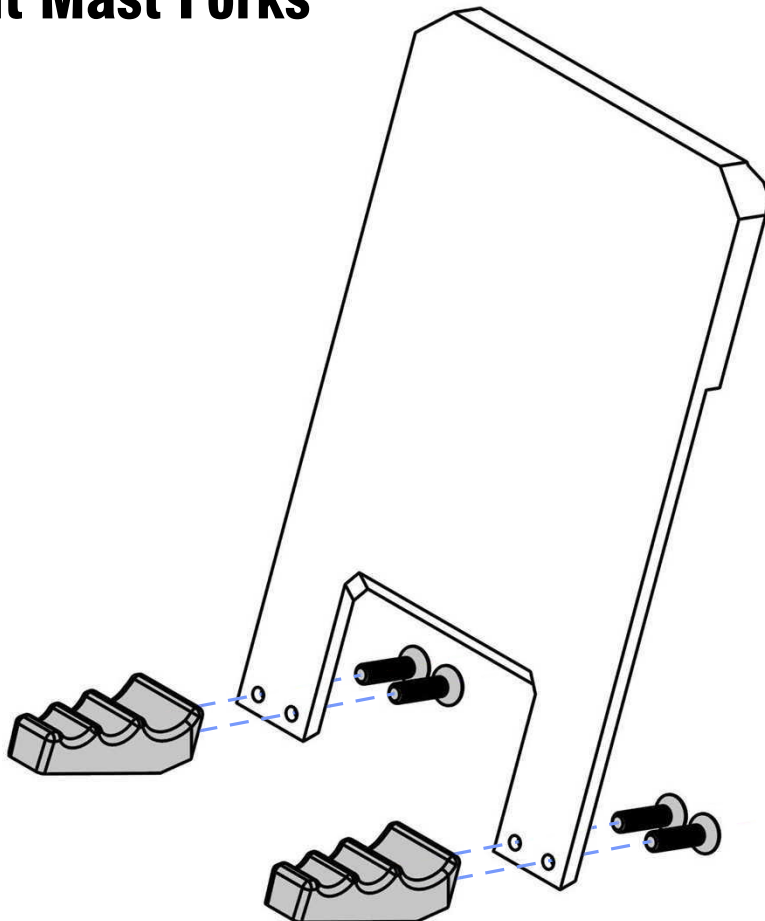

## 9 | Insert Dowel Pins

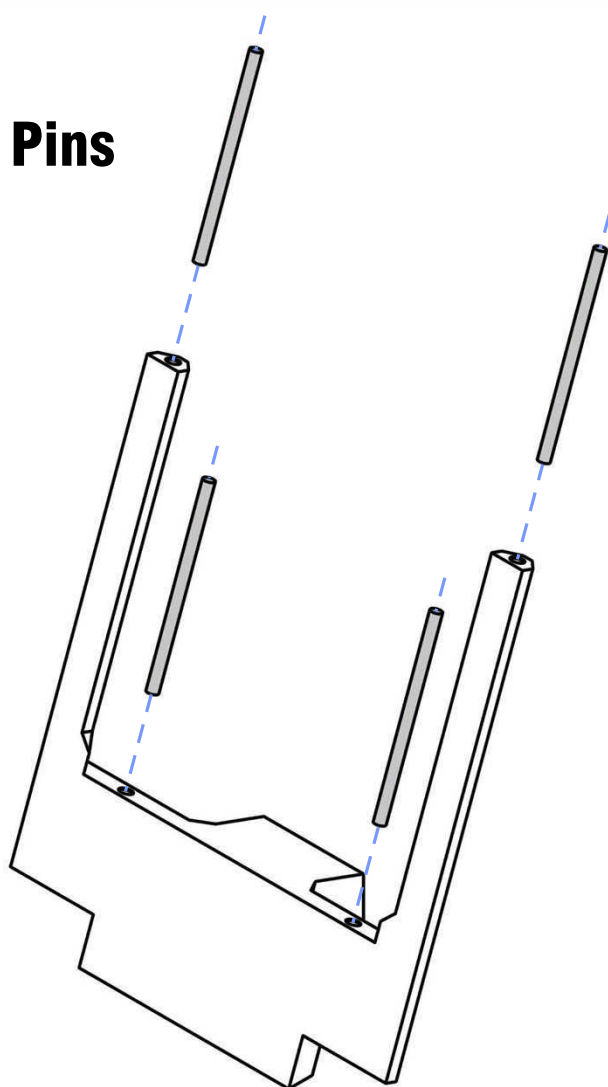

---

## 10 | Install Coil & Cover

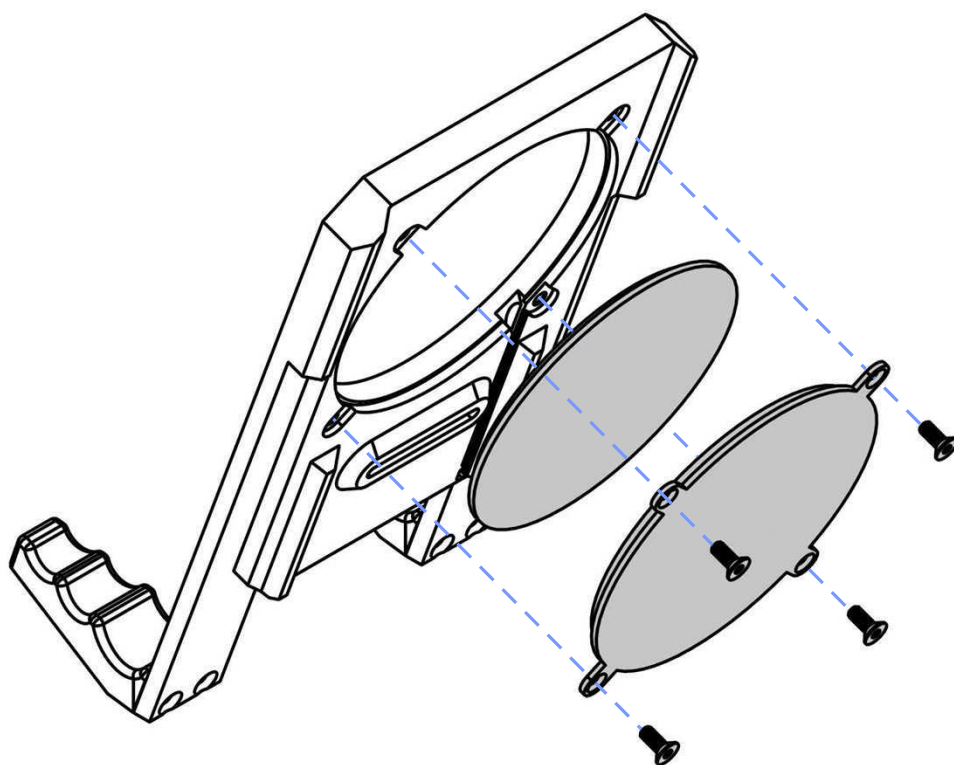

# 11 | Connect Mast Parts

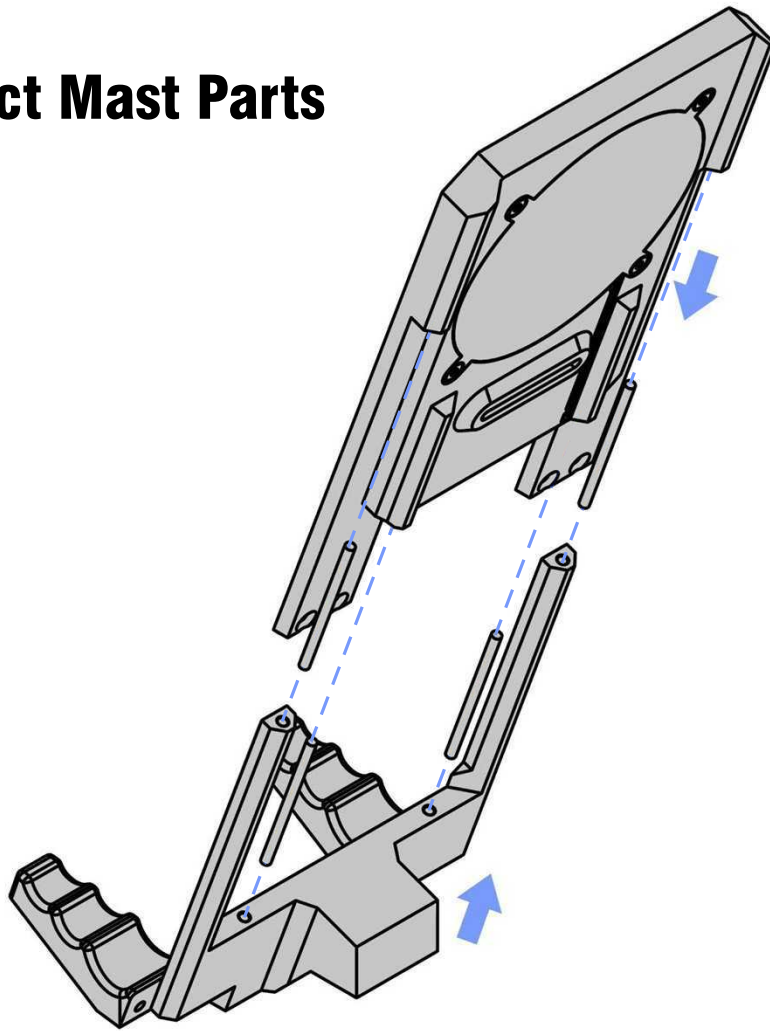

# 12 | Mount Mast To Body

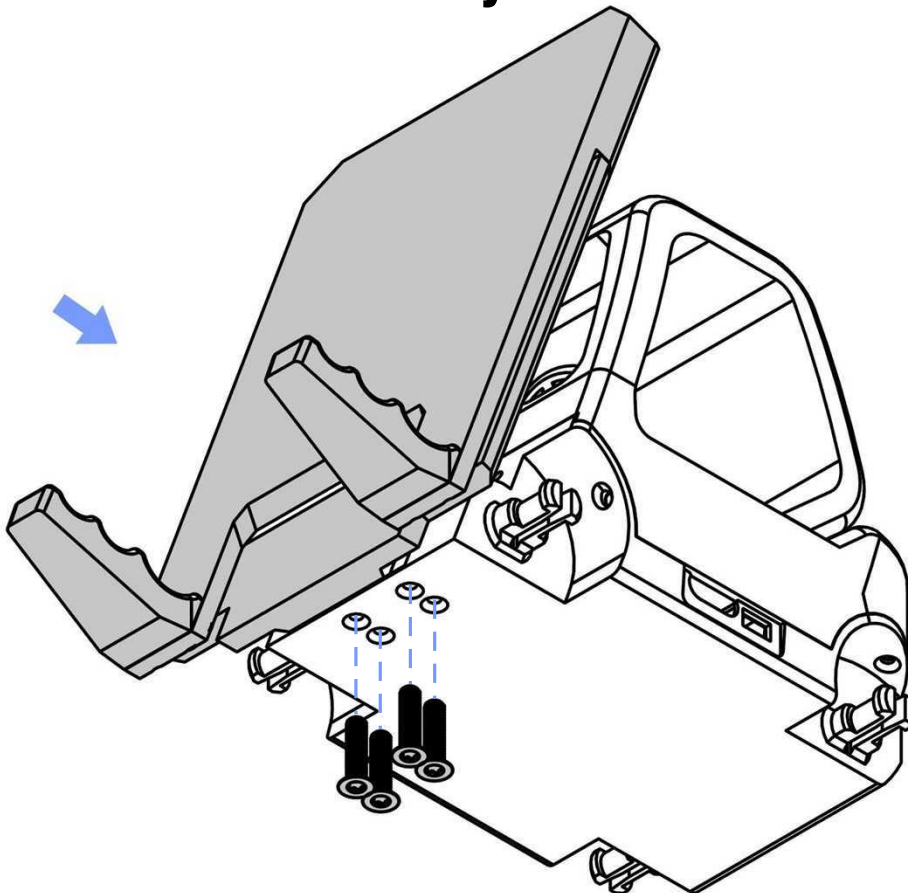



# 13

## Install Wheels

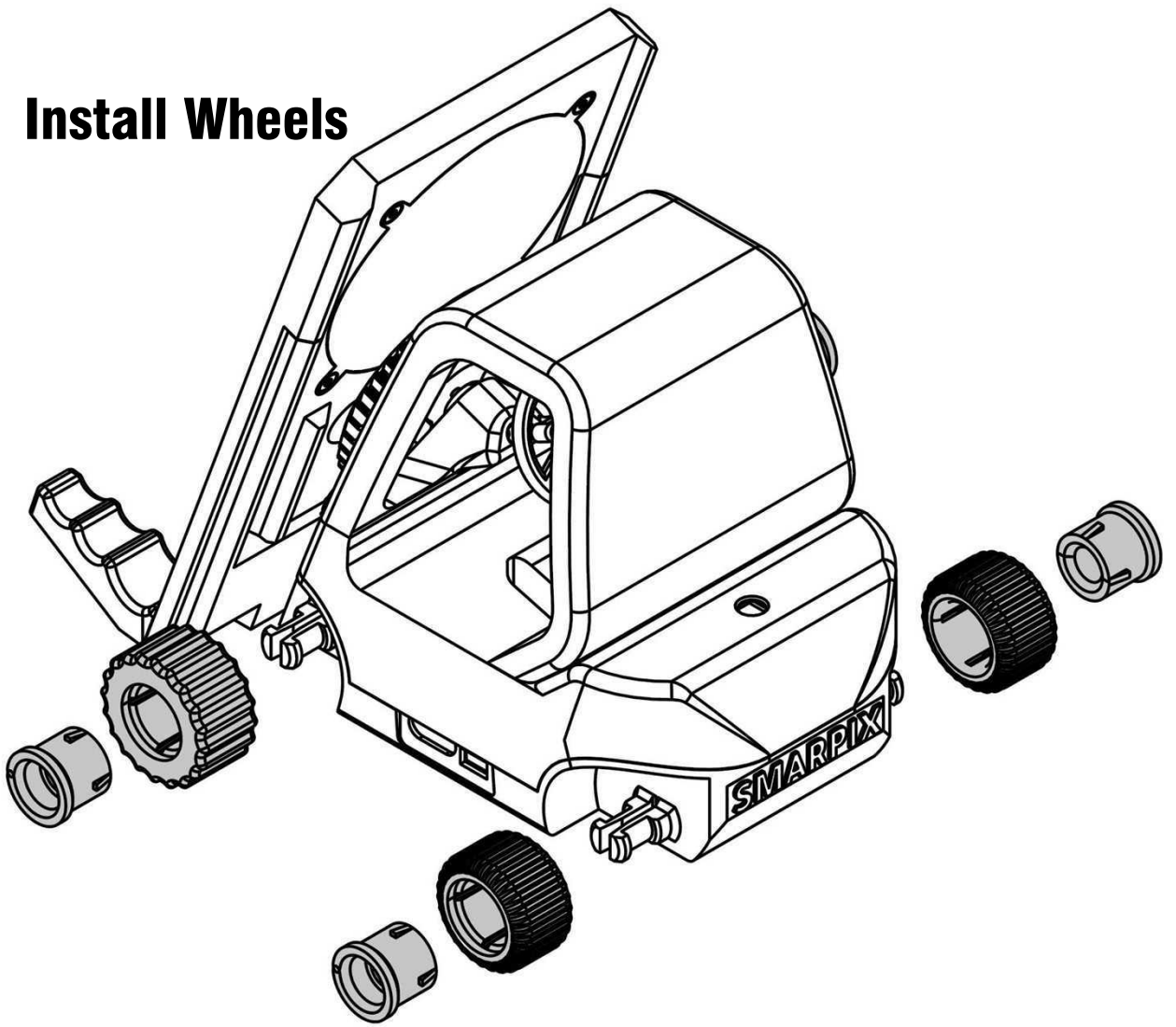

# 14

## All Done

